

December 7, 1995

Introduced By: Miller

KCWD119

Proposed No.:

96 - 035

ORDINANCE NO.

12102

1

2

3

4

5

6

AN ORDINANCE relating to the annexation of certain property one half mile N.W. of Lake Joy, to King County Water District No. 119 for the purpose of providing water service.

7

BE IT ORDAINED BY THE COUNCIL OF KING COUNTY:

8

STATEMENT OF FACT:

9

10

11

12

13

14

1. A notice of intention proposing the annexation of certain property one half mile N.W. of Lake Joy to King County Water District No. 119 for water service was filed with the county council effective December 5, 1995.

15

16

17

18

2. King County Water District No. 119 has found the petition for annexation to be sufficient and has, by Resolution No. 288, concurred with the proposed annexation.

19

20

21

22

3. King County Water District No. 119 filed a Determination of Nonsignificance dated March 2, 1994, on the proposed annexation.

23

24

25

26

4. The county council held a public hearing on the day of January 2, 19 96 and has considered the criteria set forth in R.C.W. 57.02.040.

27

28

29

30

SECTION 1. The annexation by King County Water District No. 119 of the property one half mile N.W. of Lake Joy, described in Attachment A, is approved. This proposed annexation is consistent with R.C.W. 57.02.040.

31

32

33

SECTION 2. King County Water District No. 119 is the appropriate entity to provide water service to the area proposed to be annexed.

1
2
3
4
5
6
7
8
9
10
11
12
13
14
15
16
17
18
19
20
21
22

SECTION 3. Completion of this annexation does not constitute county approval or disapproval of any other permits, certifications, or actions necessary to provide service to this annexation area.

INTRODUCED AND READ for the first time this 11th day of December, 1995.

PASSED by a vote of 12 to 0 this 2nd day of January, 1996.

KING COUNTY COUNCIL
KING COUNTY, WASHINGTON

Jane Hague
Chair

ATTEST:

Ronald G. Peterson
Clerk of the Council

APPROVED this 10th day of January, 1996.

Jay Lohr
King County Executive

Attachments: A. Legal Description
B. Map

12102

EXHIBIT "F"

LEGAL DESCRIPTION FOR NORTH LAKE JOY ANNEXATION AREA

The north 1/2 of Section 26, Township 26 North, Range 7 East, W.M.;

EXCEPT those portions thereof conveyed to the City of Seattle by deeds recorded under King County Recording Nos. 4987895, 8511131543 and 8707131141;

TOGETHER WITH the north 1/2 of the southeast 1/4, the west 1/2 of the northeast 1/4 of the southwest 1/4 and the northwest 1/4 of the southwest 1/4 of Section 26, Township 26 North, Range 7 East, W.M.;

EXCEPT that portion thereof lying southwesterly of the centerline of Lake Joy Road as conveyed by instrument recorded under Recording No. 3059059;

Situate in the County of King, State of Washington.

msh\119\lakejoy\legal

RECEIVED
95 DEC -5 AM 9:58
CLERK
KING COUNTY COUNCIL

EXHIBIT F

RECEIVED



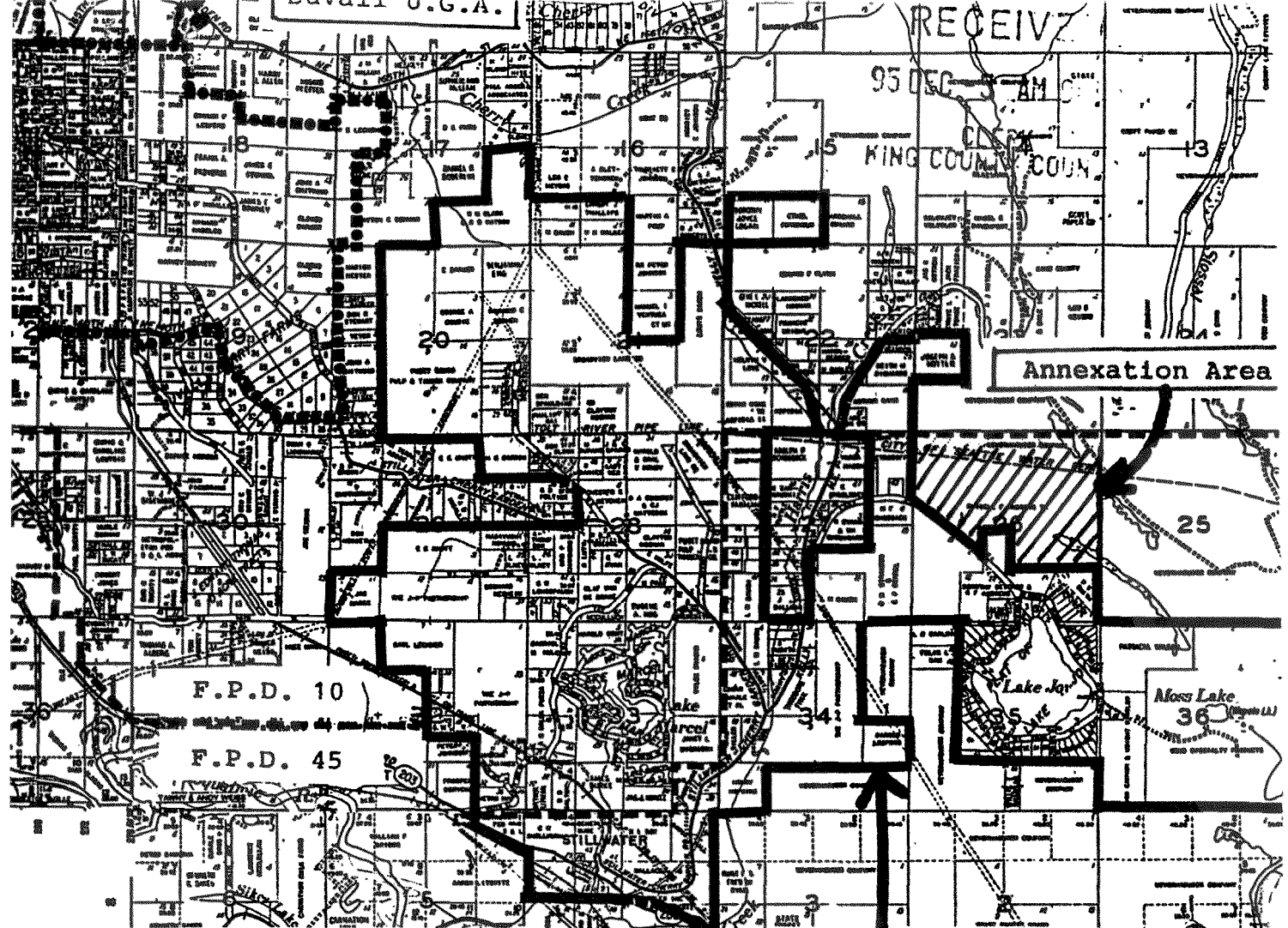

95 DEC 5 AM

KING COUNTY COUN



Annexation Area

LEGEND

-  Annexation Area (340 acres)
-  W.D. 119 Corporate Boundaries
-  Fire Prot. Dist. Boundaries
-  Urban Growth Area Boundaries

Existing Corporate Boundary

Carnation U.G.A.

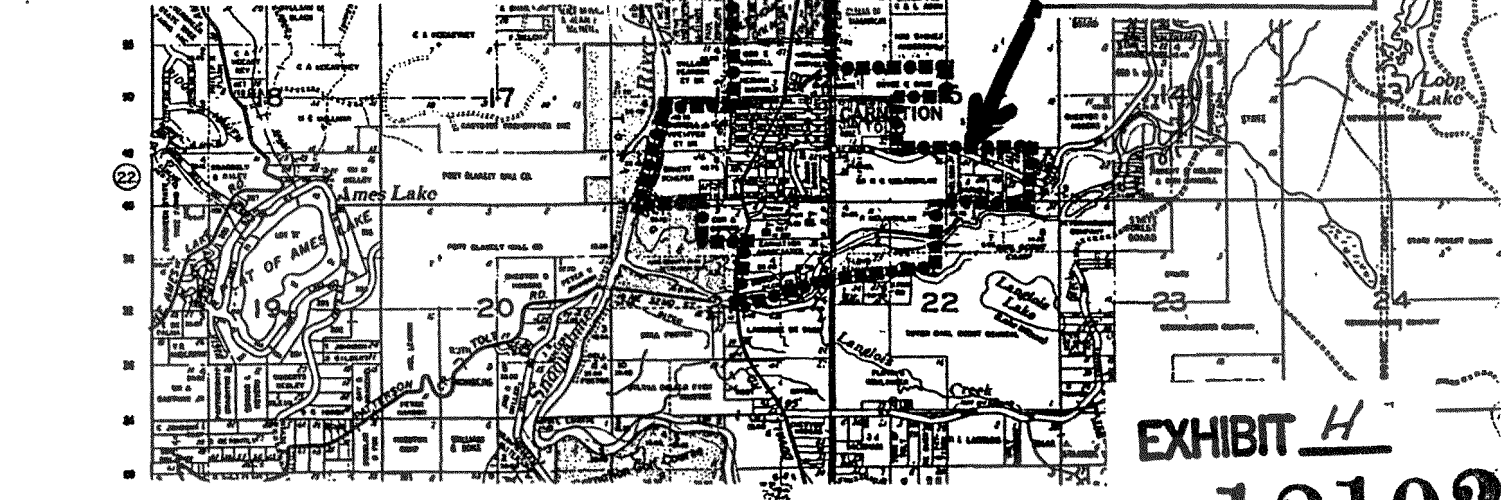

EXHIBIT H
12102

Existing Corporate Boundary

12102

EXHIBIT I

Annexation Area

Existing Corporate Boundary

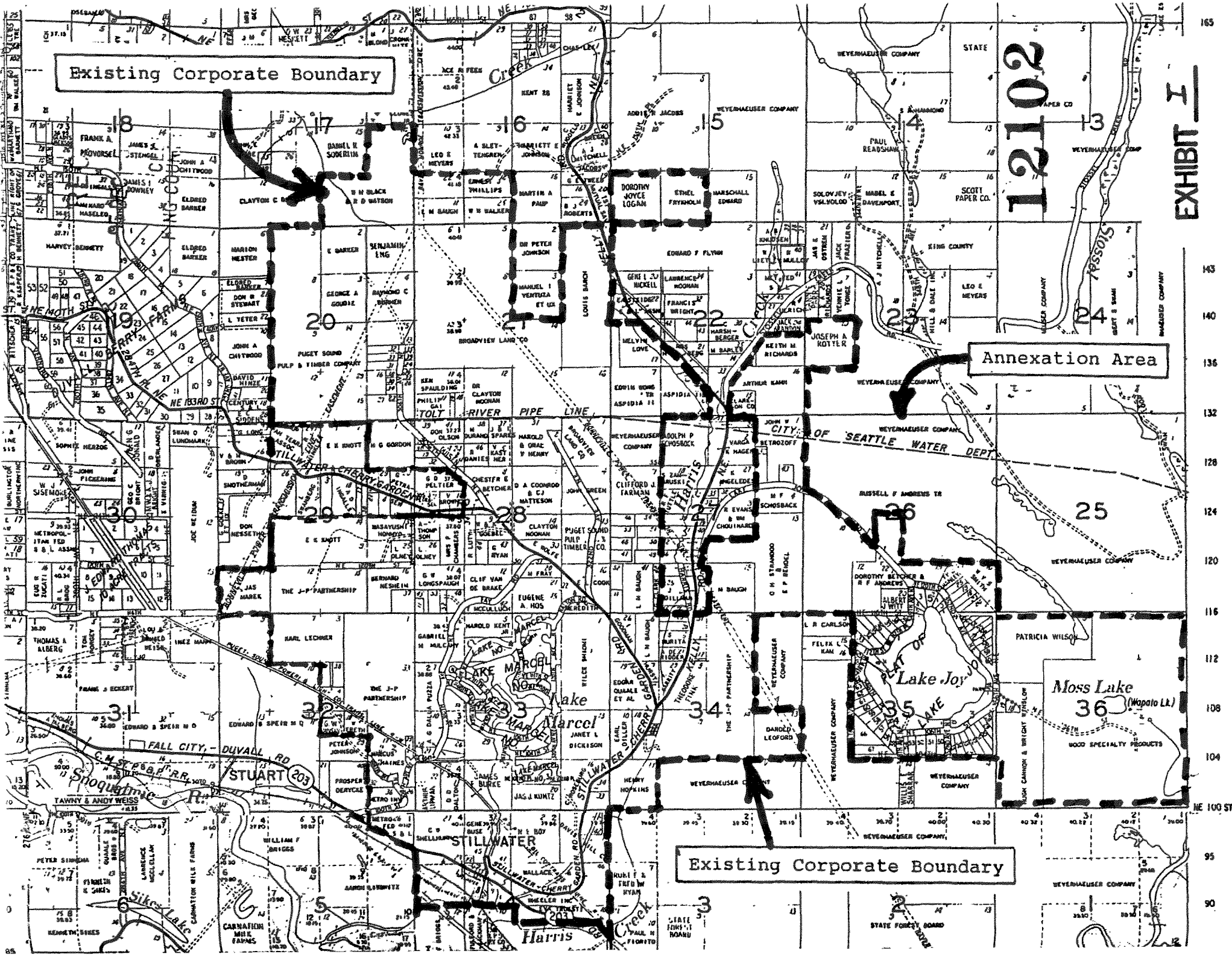

165

143

140

136

132

128

124

120

116

112

108

104

NE 100 ST

95

90